

# BS5153 / EN12334 45D FLEXIBLE SWING CHECK VALVE

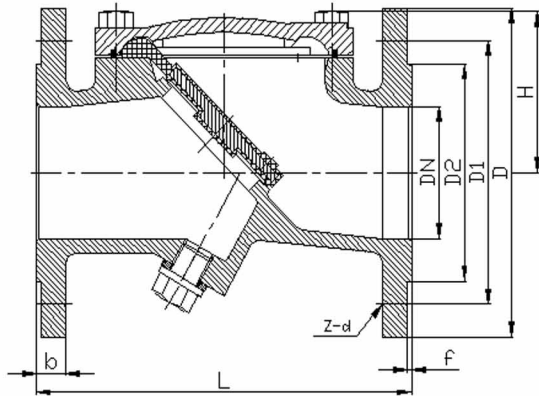

## Materials of Parts

<b>Body</b>	Ductile Iron to BS2789 Gr. 500/7
<b>Bonnet</b>	Ductile Iron to BS2789 Gr. 500/7
<b>Disc</b>	Ductile Iron+EPDM
<b>Plug</b>	Carbon Steel
<b>Gasket</b>	NBR to BS2494
<b>Bolts &amp; Nuts</b>	SS304 / Carbon Steel with Zinc

## Dimension: PN16

mm

Size	D	D1	D2	H	L	b	f	z-d	Weight kg
DN50	165	125	99	85	203	19	3	4-Ø19	11
DN65	185	145	118	92	216	19	3	4-Ø19	13
DN80	200	160	132	99	241	19	3	8-Ø19	17
DN100	220	180	156	107	292	19	3	8-Ø19	28
DN125	250	210	184	132	330	19	3	8-Ø19	38
DN150	285	240	211	152	356	19	3	8-Ø23	50
DN200	340	295	266	183	495	20	3	12-Ø23	80
DN250	405	355	319	213	622	22	3	12-Ø28	115
DN300	460	410	370	249	698	24.5	4	12-Ø28	160
DN350	520	470	429	312	787	26.5	4	16-Ø28	255
DN400	580	525	480	374	914	28	4	16-Ø31	340

Note: The illustrations in this catalogue are subject to modifications without notice.

**MINGPIN** **MPM** **METALS**

No.69 Wangjiang West Road, Hefei, China  
sales@mingpinmetals.com

T: +86-551-64211984 F: +86-551-64211974  
www.mingpinmetals.com